

**WBE CERTIFIED WOMEN BUSINESS ENTERPRISE**

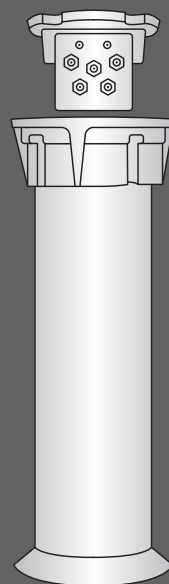

# Test & Valvco

Your Key to  
Corrosion Monitoring  
& Utility Locating



---

## TEST STATIONS

---

**CP Test & Valvco, Inc.**

205 Hallock Avenue, Middlesex, NJ 08846  
P: 201.998.1500 F: 732.424.8811  
E: [sales@cptest.com](mailto:sales@cptest.com) W: [www.cptest.com](http://www.cptest.com)



# MINI TEST STATION

# MRB TEST STATION

- Locking lid
- Ideal for tracer wire and locating

- Locking lid
- Removable bolt

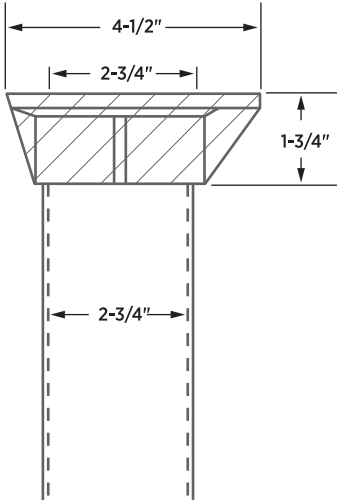

Shipping Weight: 2.5 lbs

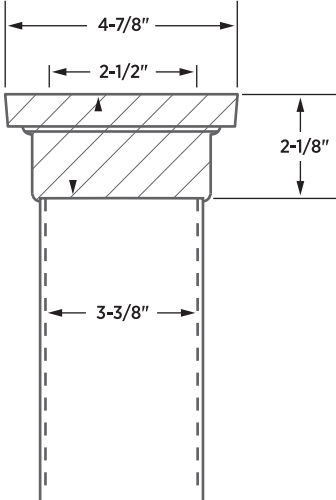

Shipping Weight: 2.5 lbs



All test stations are made of high impact A.B.S. Plastic and heavy duty cast iron collars and covers ASTM class 25 or higher

# CHIP TEST STATION

# GLENN TEST STATION

Locking lid

Locking lid  
or non-locking lid

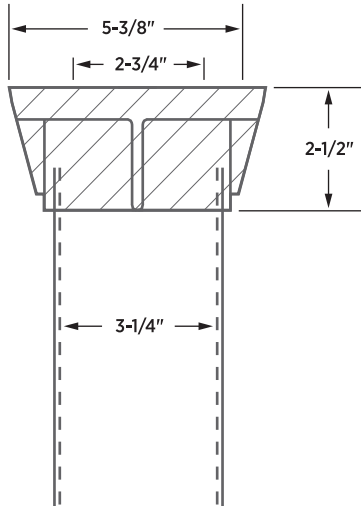

Shipping Weight: 6 lbs

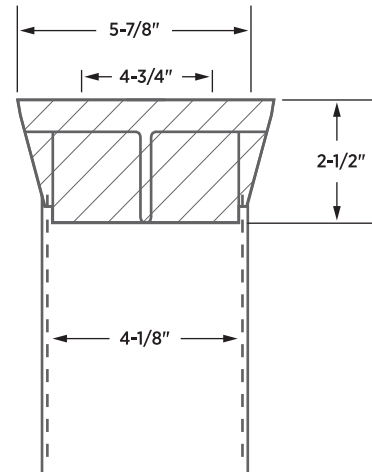

Shipping Weight: 7 lbs



Custom lettering on most models using our Foundry Pattern Inserts. Lead times are short and charges are nominal. Call for an estimate.

# NM TEST STATION

# NM 5-A TEST STATION

- Locking or non-locking lid
- 1" Repaving adapter available

Locking lid  
or non-locking lid

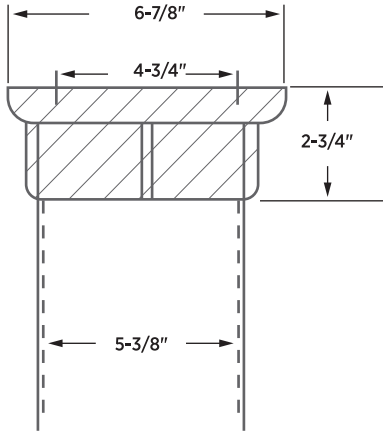

Shipping Weight: 13 lbs

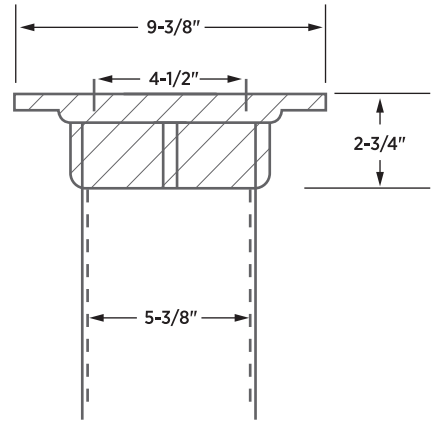

Shipping Weight: 16 lbs



- Standard shaft length is 18" - Longer or shorter shafts available
- Adjustable versions available for any test station where top section and bottom section telescope together.

# CC TEST STATION

# EQ TEST STATION

Non-locking lid

Non-locking lid

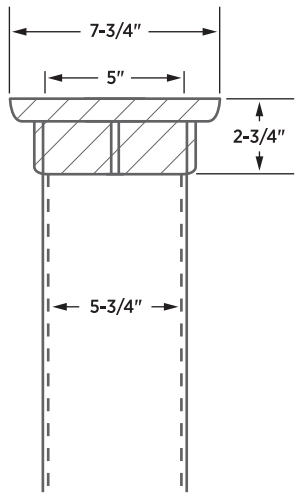

Shipping Weight: 13 lbs

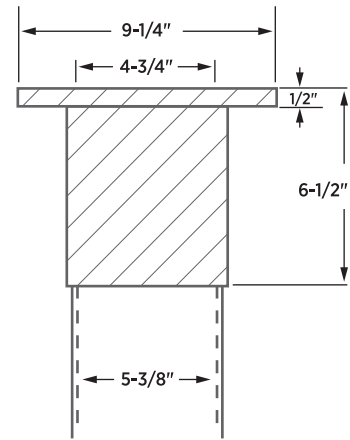

Shipping Weight: 20 lbs



- Special pentagonal key wrench available for locking test station covers.
- Full line of replacement parts and accessories kept in stock.

# #668 TEST STATION

# MARKET POST

- Locking Lid
- 1" Repaving Adapter Available

Available in a variety of heights and diameters

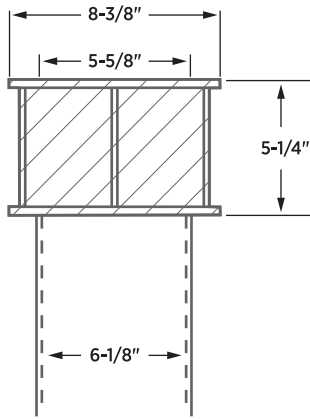

Shipping Weight: 24 lbs

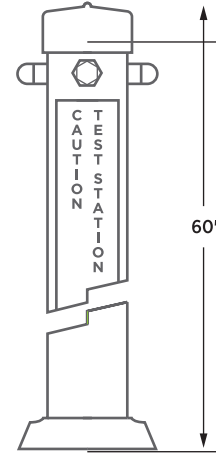

Shipping Weight: 3 lbs

H2O  
RATED  
FOR  
AIRPORT  
TRAFFIC



- Special pentagonal key wrench available for locking test station covers.
- Full line of replacement parts and accessories kept in stock.

# #178 TEST STATION

# MONITORING WELL TEST STATION

- Non-locking lid
- Extensive range of repaving adapters available

- Non-locking lid
- Watertight

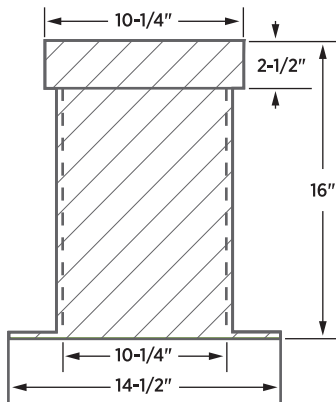

Shipping Weight: 95 lbs

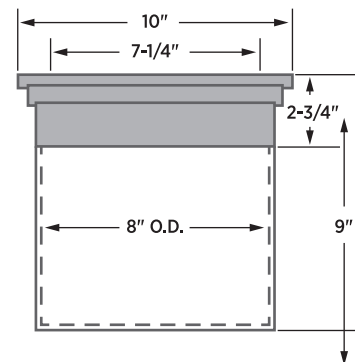

Shipping Weight: 16 lbs



- Special pentagonal key wrench available for locking test station covers.
- Full line of replacement parts and accessories kept in stock.

## OPTIONS AND PARTS AVAILABLE FOR TEST STATIONS

- Key wrench for operation of locking covers to open both locking and non-locking covers.
- Additional terminals on terminal boards.
- Shorting straps between terminals.
- Lightning gap arrestors.
- Pre-wired test stations with all types of wire gauges, colors, lengths and connectors... including 5-way binding posts.
- Adjustable test stations with separate plastic top and bottom sections.
- Custom lettering cast into cover.
- Covers painted colors other than standard yellow.

## EXCLUSIVE FEATURES

- Heavy-duty cast iron cover and collar, exceeding ASTM-A-48 Class 25... many passing DOT H-20 Roadway and/or FAA runway loading test. We will certify Made in the U.S.A.
- High quality, strong and durable ABS (acrylonitrile butadiene styrene) plastic shafts, exceeding ASTM D-1788.
- PVC (polyvinyl chloride) terminal boards. Terminal boards prolong wire life by minimizing wire strain and movement.
- Terminals are 1/4"-20" threaded stainless steel machine screws with nuts, resists corrosion for long life.
- Non-conductive plastic construction eliminates electrolytic and galvanic action to ensure accurate test readings.
- Flared plastic shaft makes test station self-leveling during installation and keeps lead wires protected.

## CP TEST & VALVCO, INC.

### **We manufacture a broad line of products including:**

- Valve boxes for gas and water utilities
- Sewer cleanout caps
- Pipeline markers
- PVC protection sleeves

Leading the industry in Test Station innovation for over 40 years

In-house design, engineering and manufacturing.

Committed to customer service, in stock inventory.

Certified Women Business Enterprise

Granted U.S. Patent #4,239,056; #4,333,494; #5,634,488 for innovations in Utility Products. Other patents pending.

### **CP Test & Valvco, Inc.**

205 Hallock Avenue, Middlesex, NJ 08846

P: 201.998.1500 F: 732.424.8811

E: sales@cptest.com W: www.cptest.com